

# LOW TORQUE SWITCHES

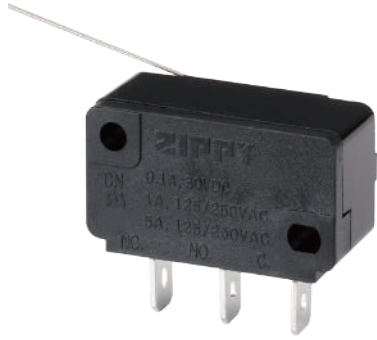

## DIMENSIONS

Unless otherwise specified, a tolerance of  $\pm 0.4\text{mm}$  applies to all dimensions.

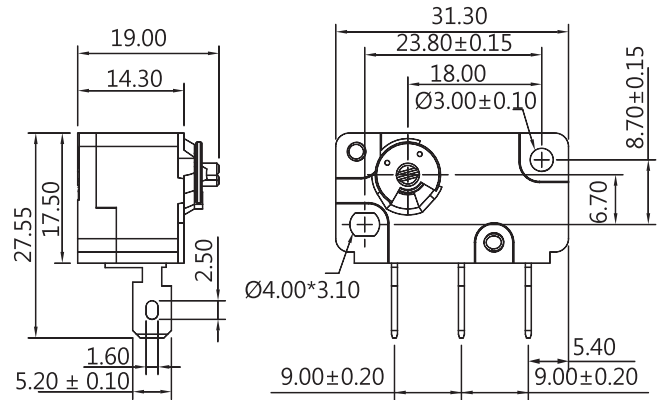

## CNR SERIES

### SPECIFICATIONS

#### Insulation Resistance ( at 500VDC/minute )

Min. 100M $\Omega$

#### Dielectric Strength

Min. 1000VAC(50-60HZ)/minute between Live parts.

Min. 1500VAC(50-60HZ)/minute between Live parts and dead metal parts

#### Operating Temperature Range

05 series -40°C to 65°C (with no icing)

P1 series -40°C to 85°C (with no icing)

#### Vibration

10~55 Hz, displacement 0.75 mm(p-p)

#### Electrical Service Life

Min. 6,000 operations

#### Electrical Operating Frequency

10~30 operations per minute

#### Mechanical Service Life

Min. 10,000,000 operations

#### Mechanical Operating Frequency

120 operations per minute

### APPLICATIONS

TV Game, Vending Machine, Coin-op Phone, Pin-Ball Game

### CONTACT CONFIGURATION

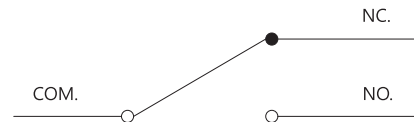

### MOUNTING HOLES

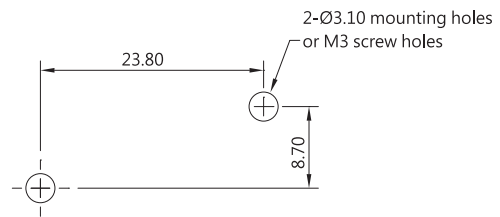

### CERTIFICATE INFORMATION

Model Name	UL, cUL
CNR-P1 CNR-05	0.1A 30VDC 1A 125/250 VAC 5A 125/250VAC Temp:85°C Min. 6,000 operations

### OPERATING CHARACTERISTICS

Type	L	S	H
Operating Force(OF)Max	5.1 gf	7.6 gf	10.2 gf
Releasing Force(RF)Min.	0.6 gf	0.9 gf	1.3 gf
Operating Position(OP)	18 $\pm$ 3°		
Releasing Position(RP)	9 $\pm$ 4°		

### THE SELECTION OF RATING & FORCE

MODEL	Rating	L	S	H
CNR	0.1A	*	*	*
	1A	*	*	*
	5A	*	*	*

NOTE : The Symbol " \* " to represent the result is accepted

ACTUATOR TYPES

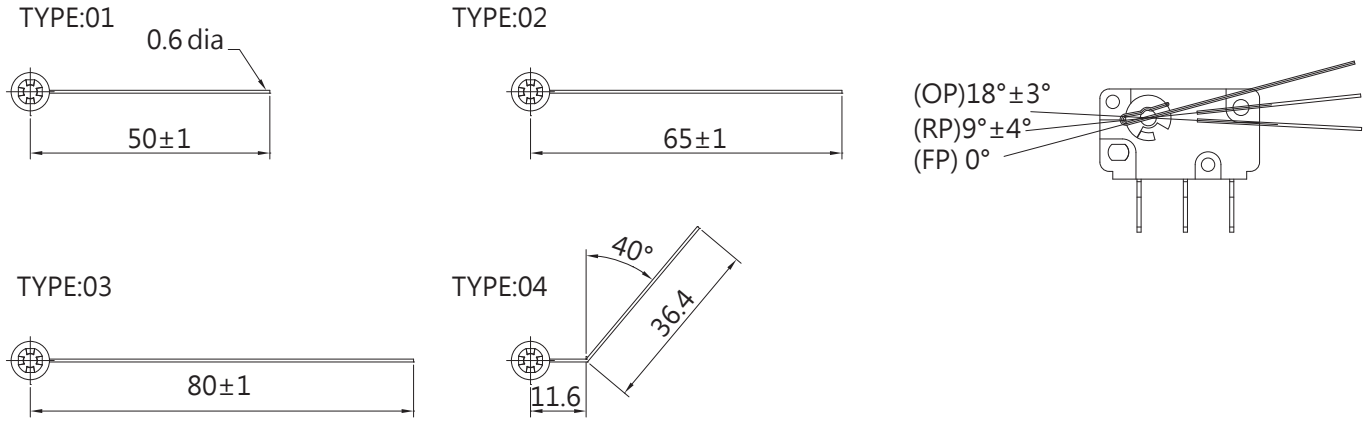

ORDERING INFORMATION

C N	R	0 5	S	0 3	Z
SERIES PREFIX	ACTUATOR DIRECTION R CLOCKWISE	RATING CURRENT P1 0.1A 125VAC 05 1A,5A 125/250VAC	OPERATING TORQUE Max. L 5.1gf-cm S 7.6gf-cm H 10.2gf-cm	ACTUATOR TYPE 01 TYPE:01 02 TYPE:02 03 TYPE:03 04 TYPE:04	ROHS CODE

#NOTE		
ITEM	RATING CURRENT	OPERATING FORCE
1	Code:P1	L,S,H
2	Code:05	L,S,H

## CAUTIONS:

### 注意事項

1. To secure the switch, please use an M3 small screw on a flat surface and tighten with plane washers or spring washers to securely mount the switch, using a maximum torque of 0.59 N•m.  
若使用定位孔型式，請使用M3小型螺絲固定在平面上，並使用平墊圈或者彈性墊圈以便安全的鎖固開關，鎖固扭力請勿超過0.59 N•m.
2. To ensure the best performance of the switch, when handling/installing the switch, please do not apply uneven pressure to the direction indicated by the arrow in (Figure -1). Any uneven pressure or pressure direction other than the operating direction might be harmful or damage the switch performance.  
為確保開關正常運作，安裝及取用開關時，請勿直接施加壓力在(圖-1)中箭所指示的方向。如圖所示，任何不對稱的壓力或作動方向以外的壓力都不適在開關按柄上。

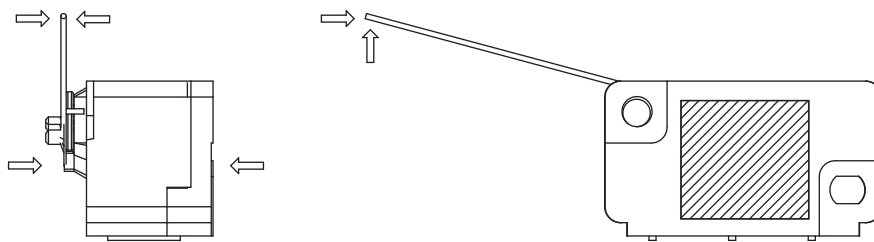

Figure-1