

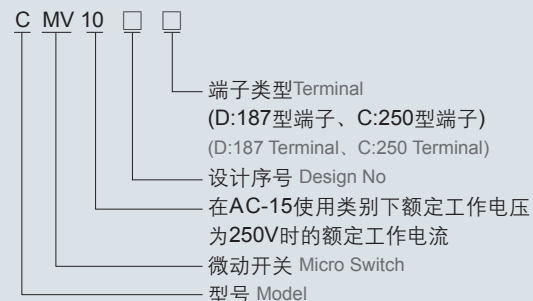

CMV 微动开关 Micro Switch

型号含义 Model Designations



性能 Performance

接触电阻 Contact resistance	15 mΩ max. (initial)
绝缘电阻 Insulation resistance	100mΩ min. (at 500VDC)
绝缘强度 Dielectric strength	1,000 VAC 50/60 Hz for 1 minute
使用寿命 Life	机械寿命: Mechanical:10,000,000 operations min. 电气寿命: Electrical:100,000 operations min.(full load)

外形图 Outer Drawing



C: 250型端子 (t=0.8)
C: 250 terminal (t=0.8)

D: 187型端子 (t=0.5)
D: 187 terminal (t=0.5)

外观和尺寸 Appearance and Dimension

CMV100D

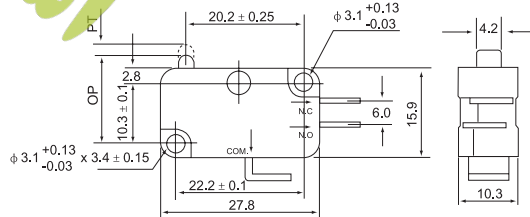

CMV101D

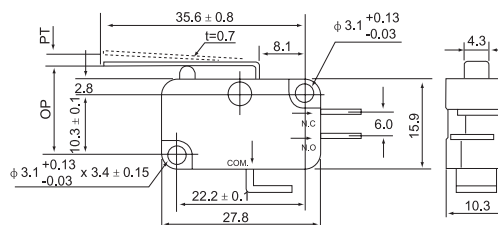

CMV102D

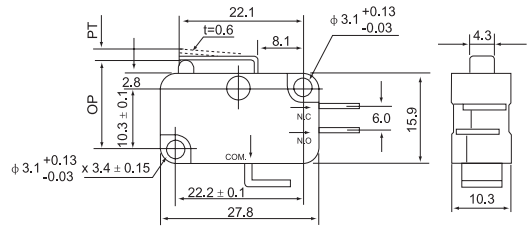

CMV103D

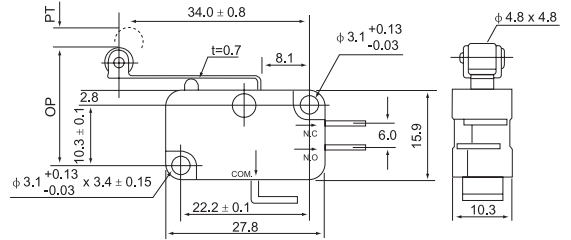

CMV104D

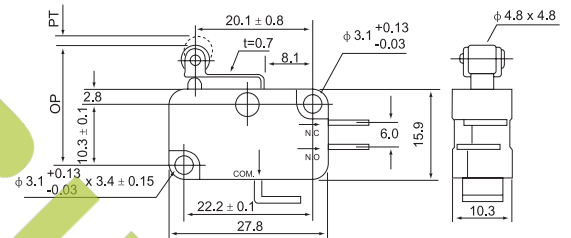

CMV105D

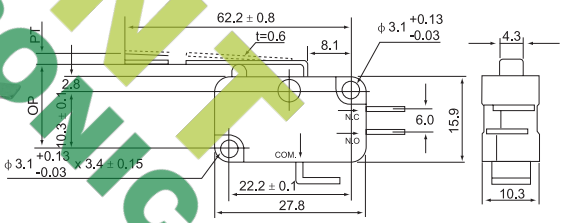

CMV106D

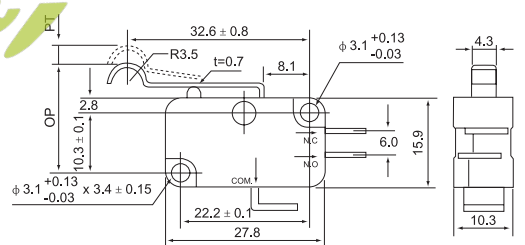

CSAQ-D

